



User's Manual

LIGHTNING MCQUEEN™ ATLAS



vtech®

© Disney/Pixar; FIAT™;
© Volkswagen AG; Jeep®
Visit disney.com/cars

© 2011 Vtech
Printed in China
91-002569-000 (美)

Dear Parent,

At **VTech**®, we know how important the first day of school is for your child. To help prepare preschoolers for this important event, **VTech**® has developed the **Preschool Learning**™ series of interactive toys.

Preschool Learning™ features fun characters and inviting school themes that use technology to capture a child's attention and teach important preschool skills like spelling, counting and the alphabet. These vital skills are taught in a way that's both fun and highly engaging to maintain a child's interest. Children will also be introduced to fun school subjects such as art class, music class and even recess! With **Preschool Learning**™, learning is fun from day one!

At **VTech**®, we know that a child has the ability to do great things. That's why all of our electronic learning products are uniquely designed to develop a child's mind and allow them to learn to the best of their ability. We thank you for trusting **VTech**® with the important job of helping your child learn and grow!

Sincerely,

Your friends at **VTech**®

To learn more about **Preschool Learning**™ series and other **VTech**® toys, visit www.vtechkids.com

INTRODUCTION

Thank you for purchasing the **VTech® Lightning McQueen™ Atlas!**

The **VTech® Lightning McQueen™ Atlas** is an exciting learning board that introduces children to a world full of exploration through 6 engaging activities. Using the touch-sensitive hotspots, your child will be able to explore and learn countries, oceans, continents, landmarks, capital cities, basic foreign language phrases and more! Cheerful music, colorful design and encouraging voice enhance the learning fun.

Big Lightning McQueen
Button

On/Off Switch

Repeat Button

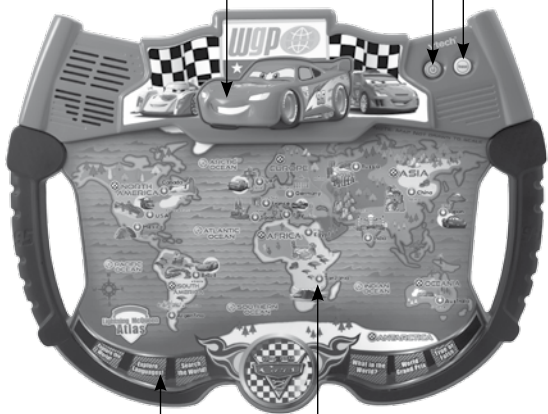

6 Activity Buttons

29 Touch-Sensitive Hotspots

INCLUDED IN THIS PACKAGE

- One **VTech® Lightning McQueen™ Atlas!**
- One user's manual

WARNING:

All packing materials, such as tape, plastic sheets, packaging locks and tags are not part of this toy, and should be discarded for your child's safety.

ATTENTION

Pour la sécurité de votre enfant, débarrassez-vous de tous les produits d'emballage tels que rubans adhésifs, feuilles de plastique, attaches et étiquettes. Ils ne font pas partie du jouet.

Demo strip removal:

When the product is taken out of the packaging, please remove the demo strip from the unit to activate normal play mode.

Unlock the packaging locks:

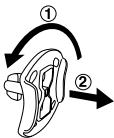

① Rotate the packaging lock counter-clockwise for 90 degrees

② Pull out the packaging lock

GETTING STARTED

BATTERY INSTALLATION

1. Make sure the unit is **OFF**.
2. Locate the battery cover on the bottom of the unit.
3. Open the battery cover.
4. Install 3 new "AA" size (AM-3/LR 6) batteries following the diagram inside the battery box. (The use of new alkaline batteries is recommended for maximum performance.)
4. R Replace the battery cover and tighten the screw to secure.

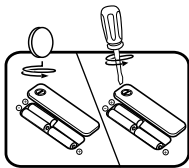

BATTERY NOTICE

- The use of new alkaline batteries is recommended for maximum performance;
- Non-rechargeable batteries are not to be recharged.
- Rechargeable batteries are to be removed from the toy before being charged (if removable).
- Rechargeable batteries are only to be charged under adult supervision (if removable).
- Do not mix old and new batteries.
- Do not mix batteries of different types: alkaline, standard (carbon-zinc) or rechargeable (nickel-cadmium)
- Only batteries of the same or equivalent type as recommended are to be used;
- Batteries are to be inserted with the correct polarity.
- Exhausted batteries are to be removed from the toy.
- The supply terminals are not to be short-circuited.
- The toy is not to be connected to more than the recommended number of power supplies.
- Do not dispose of batteries in fire.

WE DO NOT RECOMMEND THE USE OF RECHARGEABLE BATTERIES.

PRODUCT FEATURES

1. ON/OFF BUTTON

Press the **On/Off Button** to turn the unit on. Press it again to turn the unit off.



2. VOLUME CONTROL SWITCH

Slide the **Volume Control Switch** to select from low, medium and high level settings.

3. REPEAT BUTTON

Press the **Repeat Button** to repeat the previous phrase.

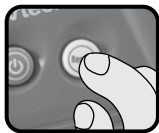

4. ACTIVITY BUTTONS

Press the 6 **Activity Buttons** to enter corresponding games to play.



5. EASY PRESS BIG LIGHTNING MCQUEEN BUTTON

Press the big **Lightning McQueen Button** to hear fun phrases about the World Grand Prix.



6. TOUCH-SENSITIVE HOTSPOTS

Press one of the 29 **Touch-Sensitive Hotspots** to hear the names of countries, oceans, continents and some fun facts, or to answer questions in related activities.



ACTIVITIES:

Activity 1: Explore the World!

Press the hotspots to learn the names and facts about 17 countries, five oceans and seven continents.

Activity 2: Explore Languages!

Press the hotspot marks for France, Germany, Japan, Italy and Spain to learn some basic phrases in different languages.

Activity 3: Search the world!

Help find the landmarks, countries, oceans or continents that we're looking for. Use the hotspots to answer.

Activity 4: What in the World?

Lightning McQueen is thinking of a place somewhere in the world. Guess what it is and use the hotspots to answer.

Activity 5: World Grand Prix Mode

Help Lightning McQueen build the longest race course in history! Press the circles that match the countries for the race.

Activity 6: True or False?

Here's a challenge for you: listen carefully to each of the questions and decide whether the facts are true or false. Press the button with Lightning's picture if you think something is true, or press one of the circles if it is false.

CARE & MAINTENANCE:

1. Keep the unit clean by wiping it with a slightly damp cloth.
2. Keep the unit out of direct sunlight and away from any direct heat sources.
3. Remove the batteries when the unit is not in use for an extended period of time.
4. Do not drop the unit on a hard surface and do not expose the unit to excess moisture.

TROUBLESHOOTING:

If for some reason the program/activity stops working or malfunctions, then please follow these steps:

1. Turn the unit **OFF**.
2. Interrupt the power supply by removing the batteries.
3. Let the unit stand for a few minutes, then replace the batteries.
4. Turn the unit back **ON**. The unit should now be ready to play again.
5. If the unit still does not work, replace with an entire set of new batteries.

If the problem persists, please call our Consumer Services Department on 1-800-521-2010 in the U.S. or 1-877-352-8697 in Canada, and a service representative will be happy to help you.

TECHNICAL SUPPORT:

If you have a problem that cannot be solved by using this manual, we encourage you to visit us online or contact our Consumer Services Department with any problems and/or suggestions that you might have. A support representative will be happy to assist you.

Before requesting support, please be ready to provide or include the information below:

- The name of your product or model number (the model number is typically located on the back or bottom of your product).
- The actual problem you are experiencing.
- The actions you took right before the problem started.

Internet: www.vtechkids.com

Phone: 1-800-521-2010 in the U.S. or 1-877-352-8697 in Canada

IMPORTANT NOTE:

Creating and developing **VTech® Preschool Learning** products is accompanied by a responsibility that we at **VTech®** take very seriously. We make every effort to ensure the accuracy of the information which forms the value of our products. However, errors sometimes can occur. It is important for you to know that we stand behind our products and encourage you to call our Consumer Services Department at 1-800-521-2010 in the U.S. or 1-877-352-8697 in Canada with any problems and/or suggestions that you might have. A service representative will be happy to help you.

NOTE:

This equipment has been tested and found to comply with the limits for a Class B digital device, pursuant to Part 15 of the FCC Rules. These limits are designed to provide reasonable protection against harmful interference in a residential installation. This equipment generates, uses and can radiate radio frequency energy and, if not installed and used in accordance with the instructions, may cause harmful interference to radio communications. However, there is no guarantee that interference will not occur in a particular installation.

If this equipment does cause harmful interference to radio or television reception, which can be determined by turning the equipment off and on, the user is encouraged to try to correct the interference by one or more of the following measures:

- Reorient or relocate the receiving antenna.
- Increase the separation between the equipment and receiver.
- Connect the equipment into an outlet on a circuit different from that to which the receiver is connected.
- Consult the dealer or an experienced radio/TV technician for help.

Caution : changes or modifications not expressly approved by the party responsible for compliance could void the user's authority to operate the equipment.

COPYRIGHT NOTICES:

Copyright ©2011 **VTech**[®] Electronics North America, L.L.C. All Rights Reserved. **VTech**[®] and the **VTech**[®] logo are registered trademarks of **VTech**[®] Electronics North America, L.L.C. All other trademarks are property of their respective owners.